

OREGON PUBLIC LAND CORNER REPORT / RESTORATION REPORT
Tillamook County Surveyor's Office

BOOK 8 233

SECTION: 7, 8, 17 & 18	TOWNSHIP: 2 South	RANGE: 9 West
COUNTY: Tillamook	DATE: 7/12/2025	
CORNER DESIGNATION: The Section Corner common to Sections 7, 8, 17, and 18 Township 2 South, Range 9 West, Willamette Meridian	(Please check one)	
	Condition Report Only	
	Restoration	
	<input checked="" type="checkbox"/> Rewitness	
	Unrecorded	
	Reset at surface	
Referenced Out		

Previous Rewitnesses, Restorations and Surveys, etc...
BLM-OREGON Field Note Volume: OR-R0053 Page: 368 (1857), Rewitness Book 4, Page 43 (1942), A-667 (1956), A-825 (1959), Rewitness Book 5, Page 144 (1970), Rewitness Card #372 (1972), Rewitness Book 6, Pages 397 (1990), Rewitness Book 7, Page 410 (2006)

History, condition, and sources:
In 1857 (BLM field notes) Samuel Snowden set a post for the Section corner common to sections 7, 8, 17, and 18. From which he established 4 bearing trees. In 1942 (Rewitness Bk. 4, Pg. 43) W.S Coats could not find the original corner, so Coats set a 2" Iron pipe from found record accessories and established 2 new accessories. In 1972 (Rewitness Card #372) Tillamook County Surveyor's office set a 2" iron pipe with a 3" Tillamook County brass cap in concrete stamped "T2SR9W S7 S8 S18 S17 RS287 1972" at surface of the road and set 5 new accessories. In 1990 (Rewitness Bk. 6 Pg. 397) Tillamook County Surveyor's office set a 10" cast iron monument box around the found 3" Tillamook County brass cap set in 1972 and added 1 new accessory. In 2006 (Rewitness Bk. 7, Pg. 410) The Tillamook County Surveyor's office found a 3" Tillamook County brass cap in a cast iron monument box as shown on Rewitness Bk. 6, Pg. 397, and set a 2" Tillamook County Surveyor brass cap on top of the monument box in concrete at road surface and set 4 new accessories. In 2025 the Tillamook County Surveyor's office found a 2" Tillamook County brass cap at road surface in concrete. The 2" Tillamook County brass cap was then removed from road surface to expose the 10" cast iron monument box and 3" Tillamook County brass cap from Rewitness Bk. 6 Pg. 397. A riser ring and lid were added to the monument box for pavement lift. Found accessories are listed below.

Found: 1" iron pipe at record location: (Rewitness Bk. 4, Pg. 43: 1" iron pipe in concrete wall S09°20'W 100.85'), (Rewitness Bk. 5 Pg. 144: 1" iron pipe in concrete wall S09°20'W 100.85'), (Rewitness Card # 372: 1" iron pipe S09°20'W 100.60'), (Rewitness Bk. 6, Pg. 397 1" iron pipe S09°20'W 100.53').

Found: 1 1/2" iron pipe S86°W 17.48': (Rewitness Card #372: 1 1/2" iron pipe S86°W 17.48'), (Rewitness Bk. 6, Pg. 397 1 1/2" iron pipe found ok in old fence line).

Found: new power pole with old power pole #171800 on it at new location S72°E 20.14': (Rewitness Card #372: power pole #4 P-55-L1 N44°E 27.45'), (Rewitness Bk. 6, Pg. 397: found record power pole at location but with new power pole # 171800).

Found: 6"x6" gate post S88°36'22" W 13.3' and added yellow metal location tag: (Rewitness Bk. 7 Pg. 410: 6"x6" gate post S88°36'22" 13.41').

New accessories set:

The monument was tied directly using GPS established control in Oregon North Zone NAD 83/91 grid coordinates in US Survey feet. Coordinates provided hereon are given in WGS 84 Latitude and Longitude.

Latitude: 45°24'18.51186"
Longitude: -123°49'28.36816"

Pictures of Found Monuments:



Location: ±1200' South on Bewley Creek Rd. 2' west of the center line in monument box lid flush with rd. surface

Tillamook County Surveyor office: 1510 3rd Street Suite C, Tillamook, OR. 97141

Party Chief: Travis Porter, Tillamook County Survey Technician III

Witnesses: Michael Rice P.L.S. 86926, Tillamook County Surveyor
Kael Pokliuha, Tillamook County Survey Technician II

Notes: Digital images taken of monument and accessories.

SURVEYOR'S SEAL

REGISTERED
PROFESSIONAL
LAND SURVEYOR

Michael Rice

OREGON
DECEMBER 11, 2012
MICHAEL R. RICE
86926

RENEWAL 12-31-2026

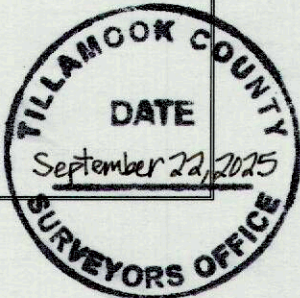

BOOK 8 233